

RIGLA METALICA TIP R9

Scara 1:20

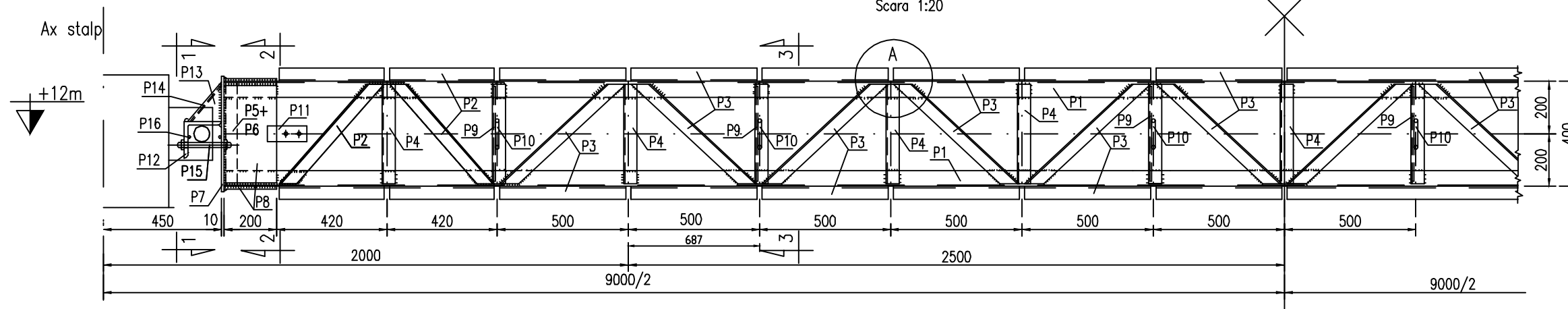

DETALIU P11

Scara 1:5

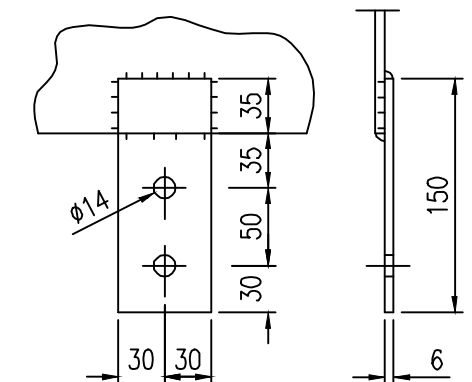

VEDERE 1-1

Scara 1:10

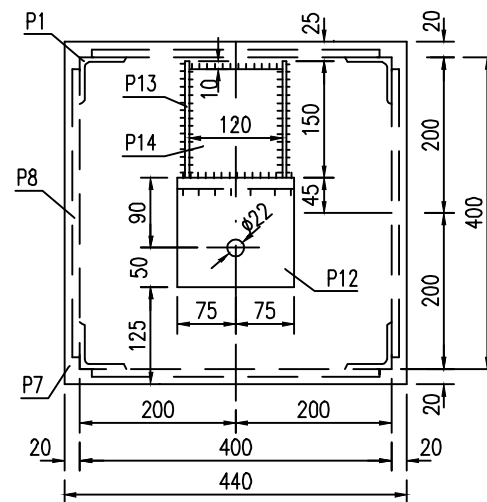

Poz. P9

Scara 1:10

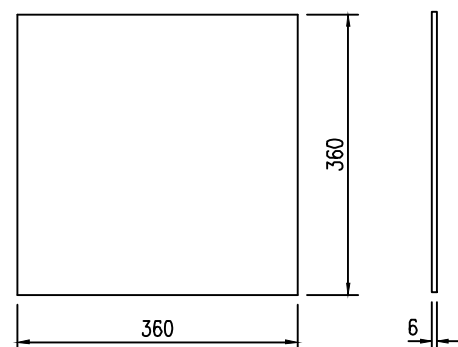

SECTIUNEA 2-2

Scara 1:10

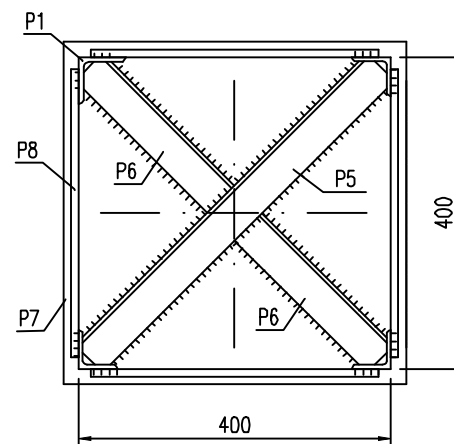

SECTIUNEA 4-4

Scara 1:5

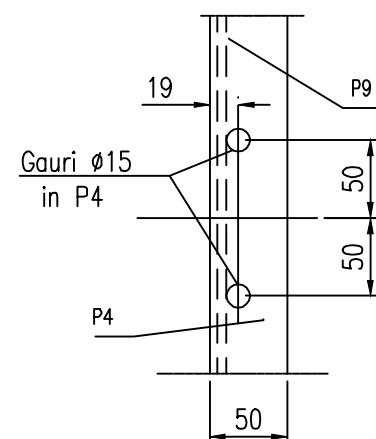

SECTIUNEA 3-3

Scara 1:10

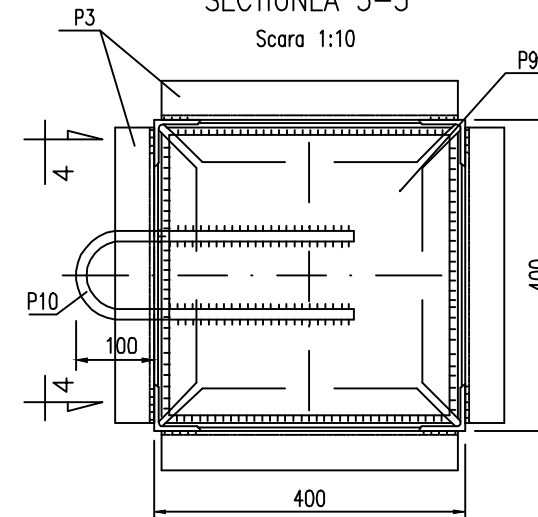

Detaliul A

Scara 1:10

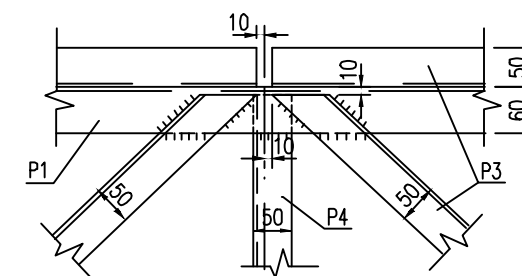

Poz. P10

Scara 1:10

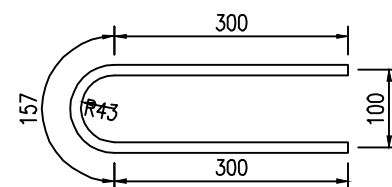





EXTRAS DE PIESE METALICE PENTRU 1 BUC. RIGLA R9

Se executa 2 buc.

Poz.	Denumirea	Dimensiuni (mm)	Lungimea (m)	Nr. bucati	MASA (kg)	
					pe buc.	totala
P1	Montant	L60x60x6	8080	4	43,80	175,20
P2	Diagonala	L50x50x5	505	16	1,90	30,40
P3	Diagonala	L50x50x5	556	48	2,10	100,80
P4	Verticala	L50x50x5	380	60	1,45	86,00
P5	Rigidizare	L50x50x5	530	2	2,00	8,00
P6	Rigidizare	L50x50x5	240	4	0,90	3,60
P7	Placa capat	440x10	440	2	15,20	30,40
P8	Placa laterala	370x10	200	8	5,80	46,40
P9	Platbanda	360x6	360	6	5,95	35,70
P10	Otel beton	Ø14	757	6	0,95	5,70
P11	Placa pamantare	60x6	150	4	0,45	1,80
P12	Piesa reazem	L140x140x14	150	2	4,20	8,40
P13	Rigidizare	150x5	130	4	0,90	3,60
P14	Rigidizare	120x5	180	2	0,85	1,70
P15	Prezon,piulite	M20	230	2	0,75	1,50
P16	Distantier	Ø14	30	4	0,025	0,10
Masa					(Kg)	540,3
1,2% electrozi + grund					(Kg)	6,5
TOTAL					(Kg)	547,8

NOTA:

- amplasarea (orientarea) riglelor pe stalpi se va face conform planului de dispozitie generala;
- rigla se va proteja anticoroziv prin zincare la cald; grosimea minima a stratului de zinc = 80µm
- sudura se va da pe toata lungimea pieselor metalice in contact, avand a = 0,7tmin, dar nu mai putin de 5 mm;
- se utilizeaza otel de uz general OL37.2, STAS 500/2-80;
- categoria "B" de executie - STAS 767/0-88;
- nivelul "C" de acceptare al imbinarilor sudate - normativ C 150-99;
- abaterile limita se vor incadra cf. STAS 767/0-88.

<div><p>PROIECTANT SPECIALITATE: AEG ELECTRICONSULT SRL Bucuresti, Sector 1, Bd Banul Marelui 27; J4014023/2023; CUI: RO 37731395 Mobil 0765.057.273; E-mail: ggg.vinatoru@gmail.com</p></div>			BENEFICIAR: DUNAREA POWER SRL		PROIECT NR EXT-166
			LOCATIE: jud. Constanta, comuna Topalu, CF 104425, 104493, 106994, 106884, 106872, 106875, 106843, 106874, 105315, 105319, 107007, 105359, 105379, 105219, 105228, 105314, 105190, 105188, 107006, 107008, 105340, 105330, 105365		
SPECIFICATIE	NUME	SEMNATURA	SCARA:	Racordare la reţeaua electrică de distribuţie a locului de producere centrală electrică eoliană şi instalaţie de stocare (CEE+ IS) Topalu (realizare staţie de transformare şi împrejmuire, realizare linie electrică subterană MT)	FAZA: DTAC
PROIECTAT	ing. ADRIAN NITA		1:10		
DESENAT	ing. IULIAN DOLAN		DATA:		
VERIFICAT	ing. GHEORGHE VÎNĂTORU		01.2026	RIGLA METALICA TIP R9	PLANŞA: IC-11.1